



EVR 2

Commercial Lighting

The EVR 2 1000W environmental shoe box luminaire is the original luminaire of this style in Australia. It provides clear, efficient illumination with minimal glare and the sharp cut-off asymmetrical reflector ensures light spill does not effect the surrounding amenity. The reflector can be rotated through 90° during manufacture to allow the fittings to be mounted in a "T" formation on the boundary. The EVR 3 packs a punch with a 1500W lamp putting a spotlight on your products.

EVR 2 1000W

SPECIFICATIONS:

Dimensions	870 x 615 x 286 mm
Weight	1000W - 35kg
Finish	Powdercoated satin black (standard)
Lamp	1000 MH (standard) (HPS available on request)
Lampholder	Porcelain E40 spring-loaded centre contact
Ballast	High power factor constant wattage suitable for lamp
Part Numbers	EVR 2: EL101015 (240V) EL101025 (415V)

FEATURES

Control Gear	Pre-wired and mounted on single tray. Fully accessible with front lens open. Concealed behind silk-screened section of lens. Integral, constant wattage.
Reflector	Sharp cut-off, forward throw high purity polished and anodised aluminium reflector.
Gasket	Twin vinyl-covered foam gaskets provide complete seal between glass frame and fixture body.
Lens	Anodised extruded aluminium frame with reinforced corners incorporates 4mm toughened glass lens, securely fastened and silicon sealed into frame. Lens frame is hinged on one side of fixture body with stainless steel fixings.
Housing	Aluminium. Completely sealed for protection from all weather conditions. Mounted via four stainless steel bolts at rear of fixture. Internal support frame to protect against body distortion.

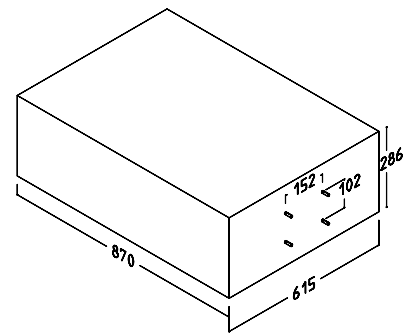

Photometrics

- Horizontal
- Vertical

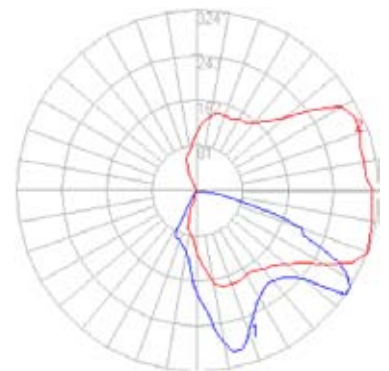

Please contact:

Aglo Systems, 9 Jarrah Drive, Braeside VIC 3195
 Phone: 03 9580 2611 Fax: 03 9580 3144 Email: sales@aglosystems.com.au
www.elscolighting.com.au

Aglo Systems Guarantee:

All bodywork guaranteed for 5 years. Control gear guaranteed for 12 months.